

STATE	FEDERAL AID PROJECT	ROUTE	STATE PROJECT	SHEET NO.
VA.		687	(NFO) 0687-082-R01	(SEE BELOW)

ROAD IMPROVEMENT PLAN
for
MASSANETTA SPRINGS ROAD
(VA ROUTE 687)
ROCKINGHAM COUNTY, VA

VALLEY ENGINEERING
IDEAS MADE REAL

3231 PEOPLES DRIVE
HARRISONBURG, VIRGINIA 22801
TELEPHONE (540) 434-6365 OR (800) 343-6365
FAX (540) 432-0685
www.valleyesp.com

COMPILED BY: VALLEY ENGINEERING, P.C. ALL RIGHTS RESERVED. THESE DRAWINGS MAY NOT BE REPRODUCED IN ANY FORM WITHOUT WRITTEN CONSENT FROM VALLEY ENGINEERING, P.C.

NOTE:
ALL EXISTING SIGNAL INFORMATION, INCLUDING NOMENCLATURE BUT EXCEPTING DETECTOR LOOPS ON ROUTE 687, ARE PER INTERSECTION ROUTES 33 AND 687 ROCKINGHAM COUNTY AS-BUILT PLANS. DETECTOR LOOP LOCATIONS ON ROUTE 687, AND SIZES ARE PER AERIAL PHOTOGRAPH AND IN-FIELD OBSERVATIONS.

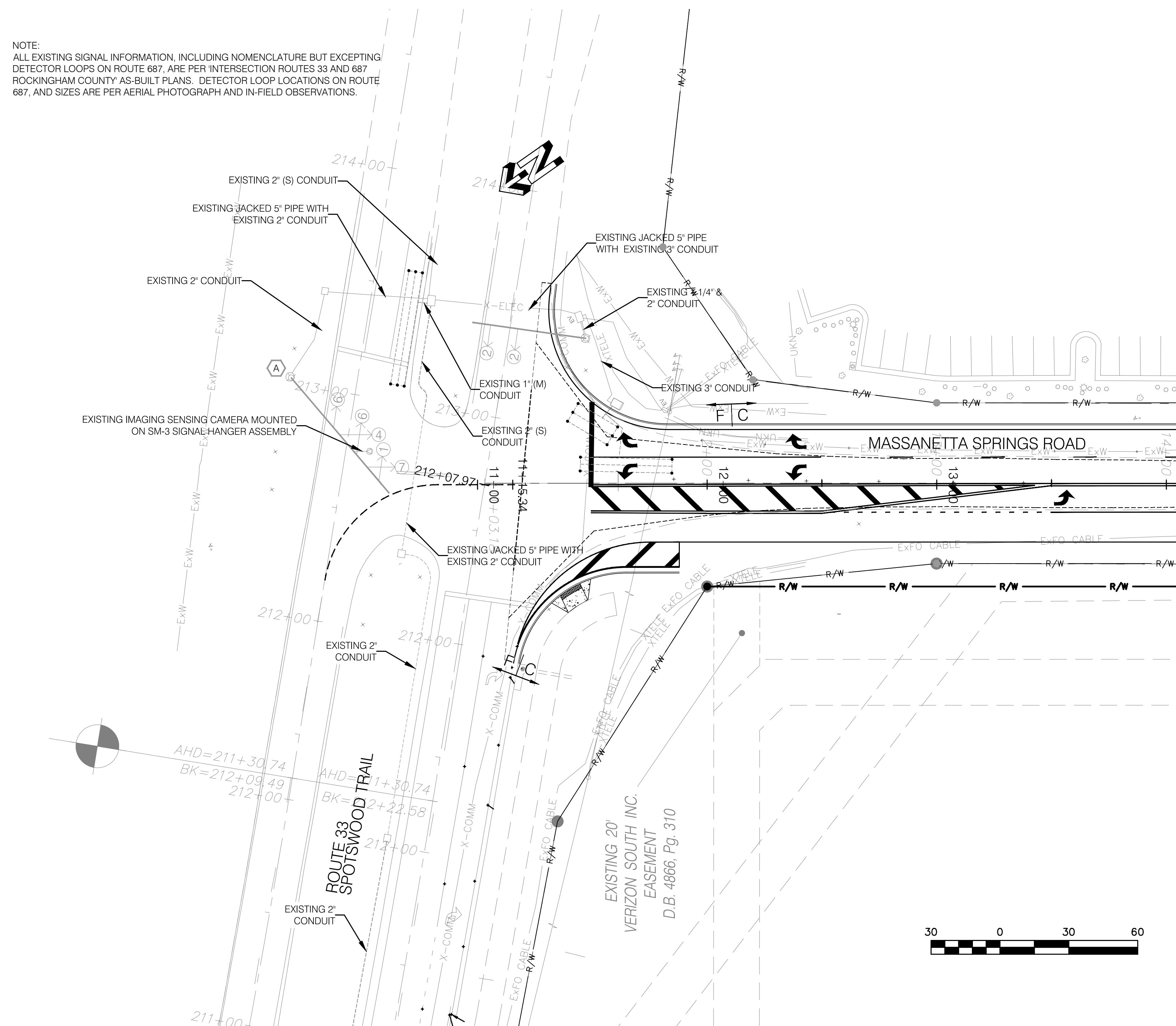

COLOR SEQUENCE CHART

PHASES	Ø1 - 6	Ø2 - 6	Ø4 - 7
1	R R R R R R	R R R R R R	R R R R R R
2	R R R R R R	G Y R Y R R	R R R R R R
4	R R R R R R	R R R R R R	G Y R Y R R
6	G G Y R G Y	R R G G R R	R R R R R R
7	R R R R R R	G Y R G G	R R R R R R

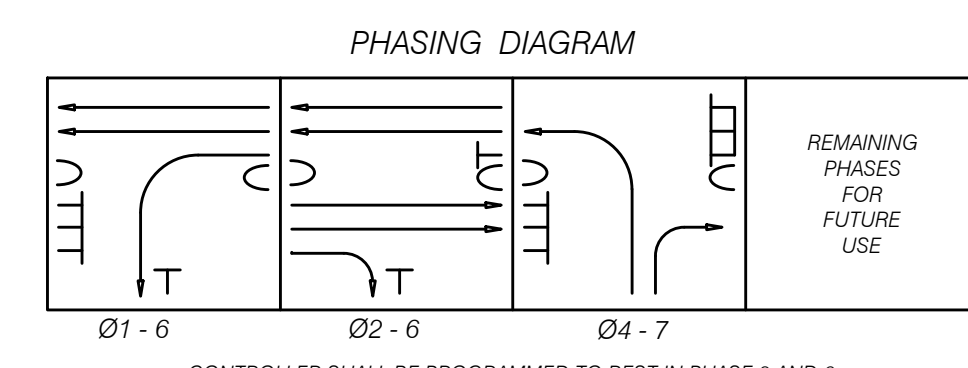

- NOTES:
- (M) DENOTES METAL CONDUIT
 - (S) DENOTES SHIELDED CONDUCTOR CABLE
 - Ø DENOTES STANDARD TD-E (MODIFIED) LOOP DETECTOR. MODIFIED TO ALLOW DRILLED CORNERS ONLY.
 - EXISTING SIGNALIZATION WAS COMPILED FROM PREVIOUS AS-BUILT PLANS AND AERIAL IMAGING.

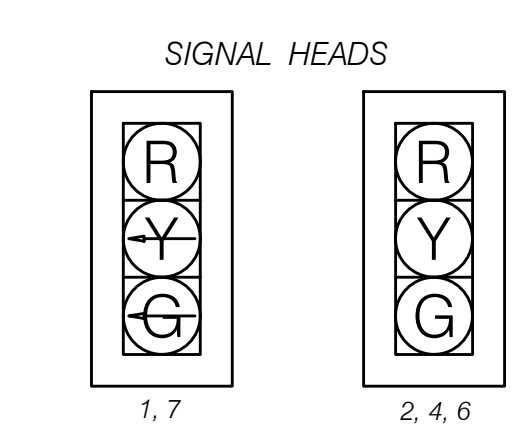

- NOTE:
- ALL SIGNALS ARE TO UTILIZE 12" LENSES.
 - ALL SIGNAL HEADS TO HAVE BACKPLATES.
 - FULL TUNNEL VISOR TO BE UTILIZED ON HEAD 1 (EXISTING).

- SIGNAL POLE LEGEND**
- POLE MAST ARM FOUNDATION TO BE REPLACED WITH NEW. REPLACE EXISTING SIGNAGE, CAMERAS, SIGNAL HEADS, WIRING, AND ANY SALVAGEABLE HARDWARE.
 - MAST ARM POLE: 65' LONG
 - POLE CENTERED AT EXISTING LOCATION
 - SIGNAL PLACEMENTS: 28.5', 32.5', 44.0', 51.0', 59.0', & 63.0'
 - SIGN PLACEMENT TO MATCH EXISTING
 - MOUNTING HEIGHT TO MATCH EXISTING
 - POLE TO BE VDOT REGIONAL. SIGNAL POLE FOUNDATION TO BE DESIGNED FOR MAX LOAD CAPACITY FOR 70' ARM



REVISIONS:
03/19/2018: PER VDOT R/W COMMENTS
05/08/2018: PER VDOT R/W COMMENTS
07/26/2018: PER VDOT AND COUNTY COMMENTS
10/26/2018: PER VDOT COMMENTS

DATE: 09/01/2015
PROJECT No.: 10498-7
EXP./CLIENT No.: 5839-6
SCALE: 1" = 30'

TRAFFIC SIGNAL PLAN

SHEET NO.:
10