

Rockingham Co Albert Long Park

Harrisonburg, VA

GRID SUMMARY

Name: **Multipurpose 3**
 Size: 360' x 225'
 Spacing: 30.0' x 30.0'
 Height: 3.0' above grade

ILLUMINATION SUMMARY

MAINTAINED HORIZONTAL FOOTCANDLES

Entire Grid

Guaranteed Average: 30

Scan Average: 31.38

Maximum: 43

Minimum: 20

Avg / Min: 1.58

Guaranteed Max / Min: 2.5

Max / Min: 2.17

UG (adjacent pts): 1.44

CU: 0.84

No. of Points: 96

LUMINAIRE INFORMATION

Color / CRI: 5700K - 75 CRI

Luminaire Output: 121,000 lumens

No. of Luminaires: 28

Total Load: 32.2 kW

Luminaire Type	L90 hrs	L80 hrs	L70 hrs	Lumen Maintenance
TLC-LED-1150	>51,000	>51,000	>51,000	>51,000
Reported per TM-21-11. See luminaire datasheet for details.				

Guaranteed Performance:

The ILLUMINATION described above is guaranteed per your Musco Warranty document and includes a 0.95 dirt depreciation factor.

Field Measurements: Individual field measurements may vary from computer-calculated predictions and should be taken in accordance with IESNA RP-6-15.

Electrical System Requirements: Refer to Amperage Draw Chart and/or the "Musco Control System Summary" for electrical sizing.

Installation Requirements: Results assume ± 3% nominal voltage at line side of the driver and structures located within 3 feet (1m) of design locations.



We Make It Happen®

Not to be reproduced in whole or part without the written consent of Musco Sports Lighting, LLC. ©1981, 2018 Musco Sports Lighting, LLC.

ILLUMINATION SUMMARY

EQUIPMENT LIST FOR AREAS SHOWN

QTY	Pole		Luminaires			
	LOCATION	SIZE	GRADE ELEVATION	MOUNTING HEIGHT	LUMINAIRE TYPE	OTHER GRID
4	S9-S12	70'	70'	70'	TLC-LED-1150	0
4	TOTALS			28	28	0

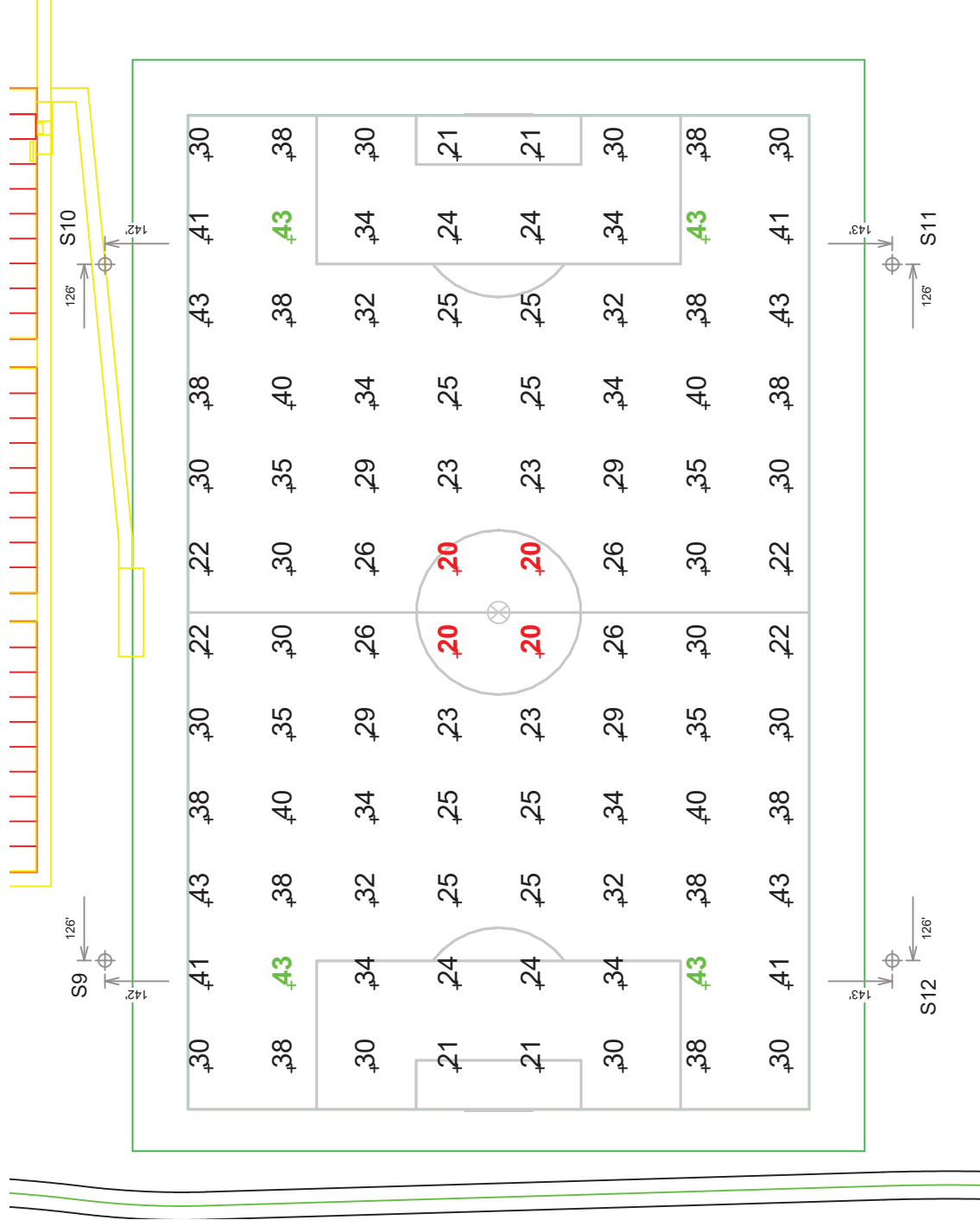

Pole location(s) Ⓢ dimensions are relative to 0,0 reference point(s) ⊗

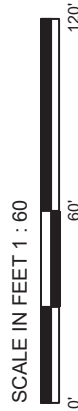

ENGINEERED DESIGN By: Jason Hoyle • File #174728A_TLC_A • 02-May-18

Rockingham Co Albert Long Park

Harrisonburg, VA

GRID SUMMARY

Name: **Multipurpose 4**
 Size: 360' x 225'
 Spacing: 30.0' x 30.0'
 Height: 3.0' above grade

ILLUMINATION SUMMARY

MAINTAINED HORIZONTAL FOOTCANDLES

Entire Grid

Guaranteed Average: 30

Scan Average: 31.38

Maximum: 43

Minimum: 20

Avg / Min: 1.58

Guaranteed Max / Min: 2.5

Max / Min: 2.17

UG (adjacent pts): 1.44

CU: 0.84

No. of Points: 96

LUMINAIRE INFORMATION

Color / CRI: 5700K - 75 CRI

Luminaire Output: 121,000 lumens

No. of Luminaires: 28

Total Load: 32.2 kW

Luminaire Type	L90 hrs	L80 hrs	L70 hrs	Lumen Maintenance
TLC-LED-1150	>51,000	>51,000	>51,000	>51,000
Reported per TM-21-11. See luminaire datasheet for details.				

Guaranteed Performance: The ILLUMINATION described above is guaranteed per your Musco Warranty document and includes a 0.95 dirt depreciation factor.

Field Measurements: Individual field measurements may vary from computer-calculated predictions and should be taken in accordance with IESNA RP-6-15.

Electrical System Requirements: Refer to Amperage Draw Chart and/or the "Musco Control System Summary" for electrical sizing.

Installation Requirements: Results assume ± 3% nominal voltage at line side of the driver and structures located within 3 feet (1m) of design locations.



We Make It Happen®

Not to be reproduced in whole or part without the written consent of Musco Sports Lighting, LLC. ©1981, 2018 Musco Sports Lighting, LLC.

ILLUMINATION SUMMARY

EQUIPMENT LIST FOR AREAS SHOWN

QTY	Pole		Luminaires			THIS GRID	OTHER GRID
	LOCATION	SIZE	GRADE ELEVATION	MOUNTING HEIGHT	LUMINAIRE TYPE		
4	S13-S16	70'	-	70'	TLC-LED-1150	7	0
4	TOTALS					28	0

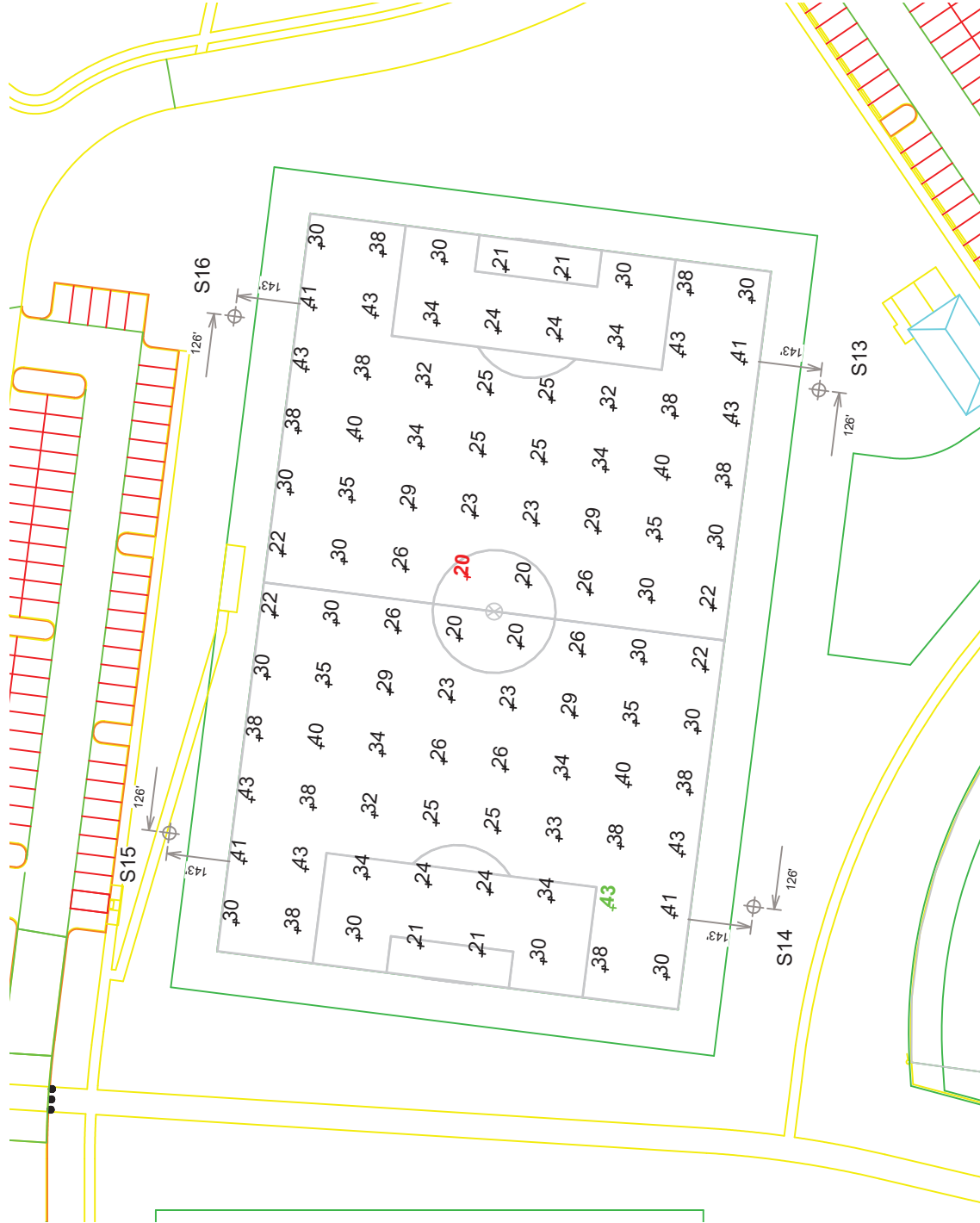

Pole location(s) ⊕ dimensions are relative to 0,0 reference point(s) ⊗

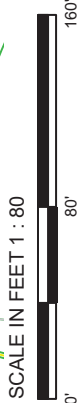

ENGINEERED DESIGN By: Jason Hoyle • File #174728A_TLC_A • 02-May-18

Rockingham Co Albert Long Park

Harrisonburg, VA

GRID SUMMARY

Name: Field 5
Size: 300' / 350' / 300' - basepath 90'
Spacing: 30.0' x 30.0'
Height: 3.0' above grade

ILLUMINATION SUMMARY

MAINTAINED HORIZONTAL FOOTCANDLES

	Infield	Outfield
Guaranteed Average:	50	30
Scan Average:	51.62	31.12
Maximum:	64	51
Minimum:	39	22
Avg / Min:	1.33	1.41
Guaranteed Max / Min:	2	2.5
Max / Min:	1.65	2.32
UG (adjacent pts):	1.33	1.64
CU:	0.79	
No. of Points:	25	88

LUMINAIRE INFORMATION	
Color / CRI:	5700K - 75 CRI
Luminaire Output:	52,000 / 121,000 lumens
No. of Luminaires:	42
Total Load:	43.7 kW

Lumen Maintenance	
Luminaire Type	L90 hrs
TLC-BT-575	>51,000
TLC-LED-1150	>51,000
	L70 hrs
	>51,000
	>51,000

Reported per TM-21-11. See luminaire datasheet for details.

Guaranteed Performance:

The ILLUMINATION described above is guaranteed per your Musco Warranty document and includes a 0.95 dirt depreciation factor.

Field Measurements: Individual field measurements may vary from computer-calculated predictions and should be taken in accordance with IESNA RP-6-15.

Electrical System Requirements: Refer to Amperage Draw Chart and/or the "Musco Control System Summary" for electrical sizing.

Installation Requirements: Results assume ± 3% nominal voltage at line side of the driver and structures located within 3 feet (1m) of design locations.



We Make It Happen®

Not to be reproduced in whole or part without the written consent of Musco Sports Lighting, LLC. ©1981, 2018 Musco Sports Lighting, LLC.

ILLUMINATION SUMMARY

EQUIPMENT LIST FOR AREAS SHOWN

QTY	Pole		MOUNTING HEIGHT	Luminaires		THIS GRID	OTHER GRIDS
	LOCATION	SIZE		LUMINAIRE TYPE	QTY / POLE		
1	A1	70'	15'	TLC-BT-575	1	1	0
	A2	70'	70'	TLC-LED-1150	5	5	0
1	A2	70'	15'	TLC-BT-575	1/1*	1	1
	B1-B2	80'	70'	TLC-LED-1150	5/5*	5	5
2	B1-B2	80'	15'	TLC-BT-575	1	1	0
	C1-C2	70'	80'	TLC-LED-1150	7	7	0
	C1-C2	70'	15'	TLC-BT-575	2	2	0
	C1-C2	70'	70'	TLC-LED-1150	5	5	0
6	TOTALS				48	42	6

* This structure utilizes a back-to-back mounting configuration

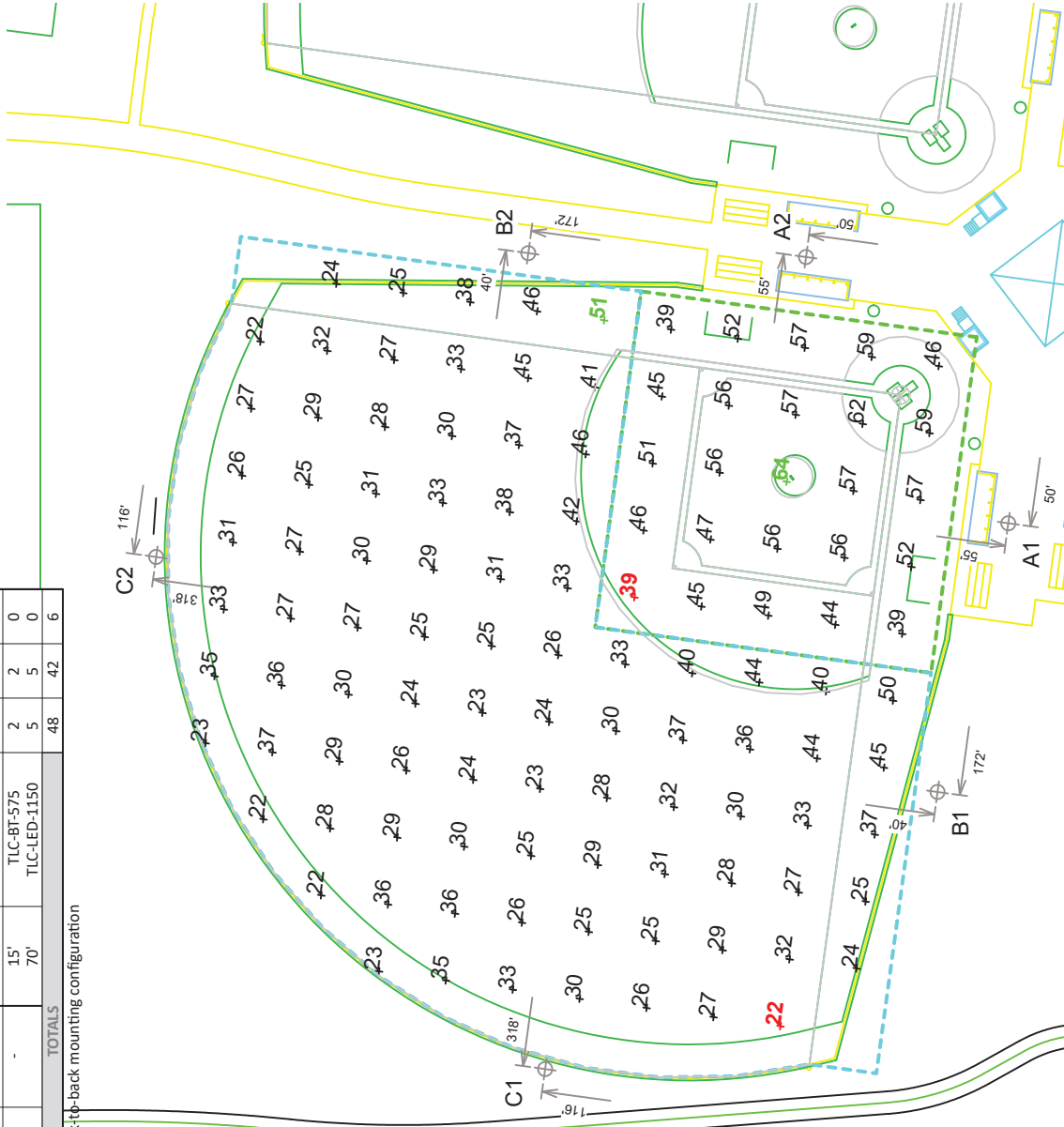

Pole location(s) ⊕ dimensions are relative to 0,0 reference point(s) ⊗

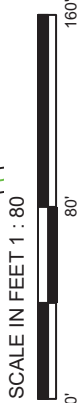

ENGINEERED DESIGN By: Jason Hoyle • File #174728A_TLC_A • 02-May-18

Rockingham Co Albert Long Park

Harrisonburg, VA

GRID SUMMARY

Name: **Field 6**
 Size: 334.4' x 334.4'
 Spacing: 30.0' x 30.0'
 Height: 3.0' above grade

ILLUMINATION SUMMARY

MAINTAINED HORIZONTAL FOOTCANDLES

	Infield	Outfield
Guaranteed Average:	50	30
Scan Average:	53.16	30.54
Maximum:	65	53
Minimum:	36	22
Avg / Min:	1.46	1.39
Guaranteed Max / Min:	2	2.5
Max / Min:	1.78	2.41
UG (adjacent pts):	1.42	1.49
No. of Points:	25	80

LUMINAIRE INFORMATION

Color / CRI: 5700K - 75 CRI
 Luminaire Output: 52,000 / 121,000 lumens
 No. of Luminaires: 42
 Total Load: 43.7 kW

Luminaire Type	L90 hrs	L80 hrs	L70 hrs
TLC-BT-575	>51,000	>51,000	>51,000
TLC-LED-1150	>51,000	>51,000	>51,000

Reported per TM-21-11. See luminaire datasheet for details.

Guaranteed Performance:

The ILLUMINATION described above is guaranteed per your Musco Warranty document and includes a 0.95 dirt depreciation factor.

Field Measurements: Individual field measurements may vary from computer-calculated predictions and should be taken in accordance with IESNA RP-6-15.

Electrical System Requirements: Refer to Amperage Draw Chart and/or the "Musco Control System Summary" for electrical sizing.

Installation Requirements: Results assume ± 3% nominal voltage at line side of the driver and structures located within 3 feet (1m) of design locations.



We Make It Happen®

Not to be reproduced in whole or part without the written consent of Musco Sports Lighting, LLC. ©1981, 2018 Musco Sports Lighting, LLC.

ILLUMINATION SUMMARY

EQUIPMENT LIST FOR AREAS SHOWN

QTY	Pole		Luminaires			THIS GRID	OTHER GRIDS	
	LOCATION	SIZE	GRADE ELEVATION	MOUNTING HEIGHT	LUMINAIRE TYPE			
1	A2	70'	-	15'	TLC-BT-575	1	1	
1	A4	70'	-	70'	TLC-LED-1150	5	5	
1	A4	70'	-	15'	TLC-BT-575	1	0	
2	B3-B4	80'	-	70'	TLC-LED-1150	5	0	
2	B3-B4	80'	-	80'	TLC-BT-575	1	0	
2	C3-C4	70'	-	70'	TLC-LED-1150	7	0	
2	C3-C4	70'	-	15'	TLC-BT-575	2	0	
2	C3-C4	70'	-	70'	TLC-LED-1150	5	0	
6	TOTALS					48	42	6

* This structure utilizes a back-to-back mounting configuration

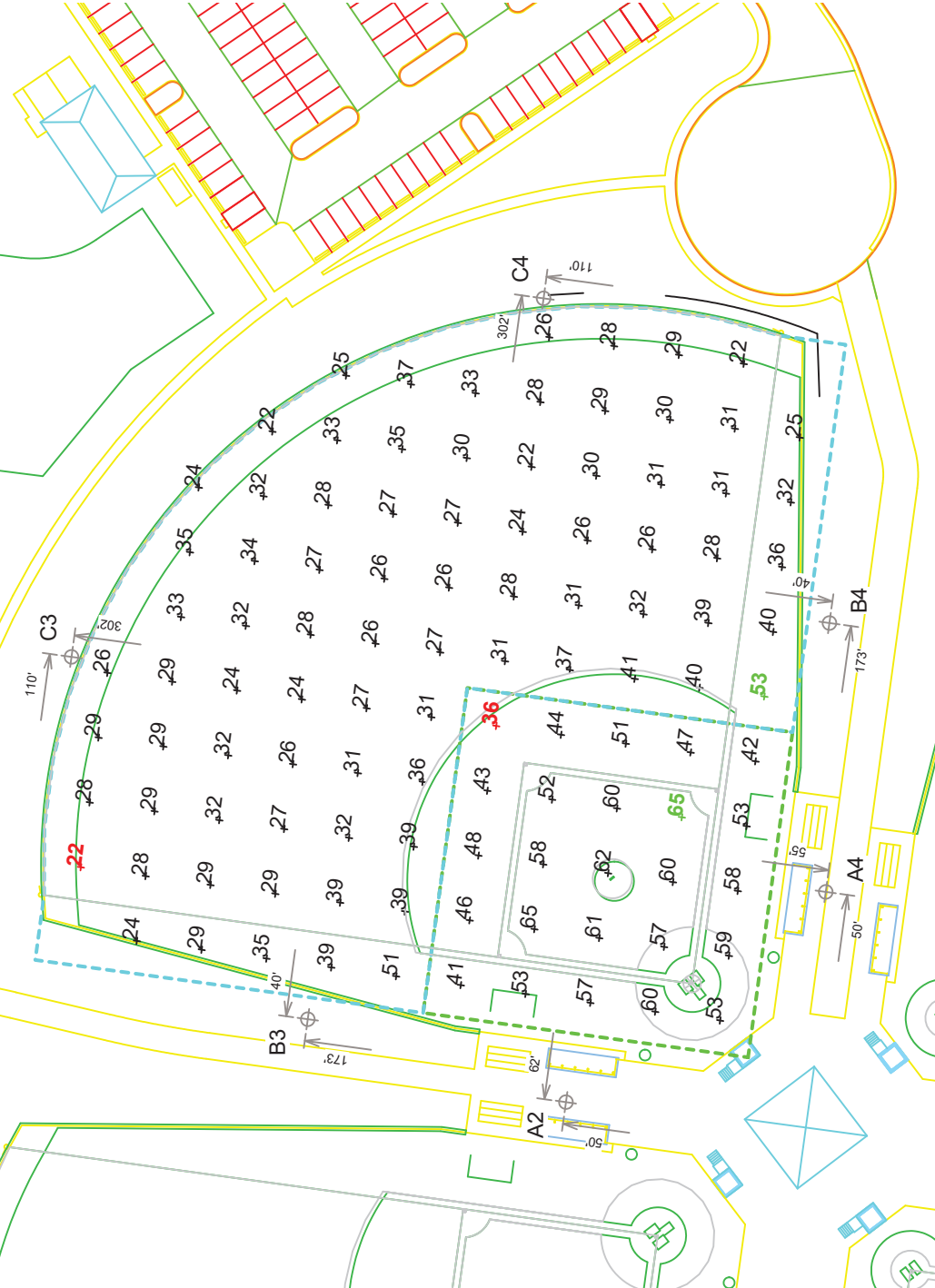

SCALE IN FEET 1 : 80



Pole location(s) Ⓢ dimensions are relative to 0,0 reference point(s) ⊗

ENGINEERED DESIGN By: Jason Hoyle • File #174728A_TLC_A • 02-May-18

Rockingham Co Albert Long Park

Harrisonburg, VA

GRID SUMMARY

Name: Field 7
Size: 250'/250'/250' - basepath 60'
Spacing: 20.0' x 20.0'
Height: 3.0' above grade

ILLUMINATION SUMMARY

MAINTAINED HORIZONTAL FOOTCANDLES

	Infield	Outfield
Guaranteed Average:	50	30
Scan Average:	55.93	31.42
Maximum:	70	49
Minimum:	36	21
Avg / Min:	1.54	1.50
Guaranteed Max / Min:	2	2.5
Max / Min:	1.94	2.33
UG (adjacent pts):	1.43	1.83
CU:	0.74	
No. of Points:	25	119

LUMINAIRE INFORMATION

Color / CRI: 5700K - 75 CRI
 Luminaire Output: 52,000 / 121,000 lumens
No. of Luminaires: 26
 Total Load: 26.45 kW

Luminaire Type	L90 hrs	L80 hrs	L70 hrs
TLC-BT-575	>51,000	>51,000	>51,000
TLC-LED-1150	>51,000	>51,000	>51,000

Reported per TM-21-11. See luminaire datasheet for details.

Guaranteed Performance: The ILLUMINATION described above is guaranteed per your Musco Warranty document and includes a 0.95 dirt depreciation factor.

Field Measurements: Individual field measurements may vary from computer-calculated predictions and should be taken in accordance with IESNA RP-6-15.

Electrical System Requirements: Refer to Amperage Draw Chart and/or the "Musco Control System Summary" for electrical sizing.

Installation Requirements: Results assume ± 3% nominal voltage at line side of the driver and structures located within 3 feet (1m) of design locations.



We Make It Happen®

Not to be reproduced in whole or part without the written consent of Musco Sports Lighting, LLC. ©1981, 2018 Musco Sports Lighting, LLC.

ILLUMINATION SUMMARY

EQUIPMENT LIST FOR AREAS SHOWN

QTY	Pole		Luminaires					
	LOCATION	SIZE	GRADE ELEVATION	MOUNTING HEIGHT	LUMINAIRE TYPE	QTY/ POLE	THIS GRID	OTHER GRIDS
4	A3, A5 C5-C6	60'	-	60'	TLC-LED-1150	3	3	0
2	B5-B6	60'	-	15'	TLC-BT-575	1	1	0
				60'	TLC-LED-1150	4	4	0
6	TOTALS					26	26	0

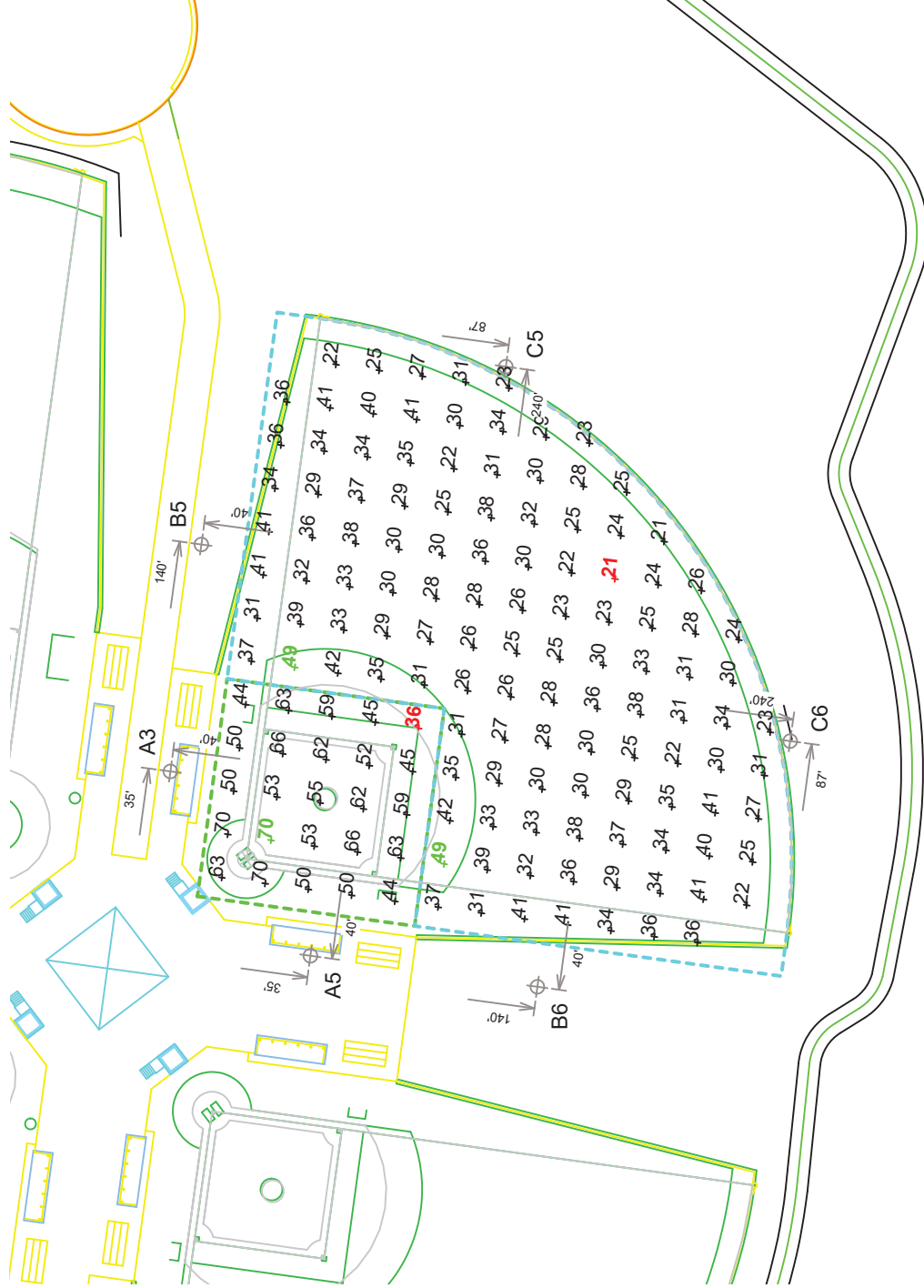

SCALE IN FEET 1 : 80



Pole location(s) ⊕ dimensions are relative to 0,0 reference point(s) ⊗

ENGINEERED DESIGN By: Jason Hoyle • File #174728A_TLC_A • 02-May-18

Rockingham Co Albert Long Park

Harrisonburg, VA

GRID SUMMARY

Name: **Field 8**

Size: 250' / 250' / 250' - basepath 60'

Spacing: 20.0' x 20.0'

Height: 3.0' above grade

ILLUMINATION SUMMARY

MAINTAINED HORIZONTAL FOOTCANDLES

	Infield	Outfield
Guaranteed Average:	50	30
Scan Average:	55.46	31.46
Maximum:	70	49
Minimum:	37	20
Avg / Min:	1.51	1.56
Guaranteed Max / Min:	2	2.5
Max / Min:	1.90	2.43
UG (adjacent pts):	1.54	1.83
CU:	0.74	
No. of Points:	25	119

Color / CRI: 5700K - 75 CRI

Luminaire Output: 52,000 / 121,000 lumens

No. of Luminaires: **26**

Total Load: 26.45 kW

LUMINAIRE INFORMATION

Luminaire Type	L80 hrs	L90 hrs	L70 hrs
TLC-BT-575	>51,000	>51,000	>51,000
TLC-LED-1150	>51,000	>51,000	>51,000

Reported per TM-21-11. See luminaire datasheet for details.

Guaranteed Performance:

The ILLUMINATION described above is guaranteed per your Musco Warranty document and includes a 0.95 dirt depreciation factor.

Individual field measurements may vary from computer-calculated predictions and should be taken in accordance with IESNA RP-6-15.

Electrical System Requirements: Refer to Amperage Draw Chart and/or the "Musco Control System Summary" for electrical sizing.

Installation Requirements: Results assume ± 3% nominal voltage at line side of the driver and structures located within 3 feet (1m) of design locations.



We Make It Happen®

Not to be reproduced in whole or part without the written consent of Musco Sports Lighting, LLC. ©1981, 2018 Musco Sports Lighting, LLC.

ILLUMINATION SUMMARY

EQUIPMENT LIST FOR AREAS SHOWN

QTY	Pole		Luminaires			THIS GRID	OTHER GRIDS
	LOCATION	SIZE	GRADE ELEVATION	MOUNTING HEIGHT	LUMINAIRE TYPE		
4	A6-A7 C7-C8	60'	-	60'	TLC-LED-1150 TLC-BT-575	3	0
2	B7-B8	60'	-	15'	TLC-BT-575 TLC-LED-1150	1	0
6	TOTALS					26	0

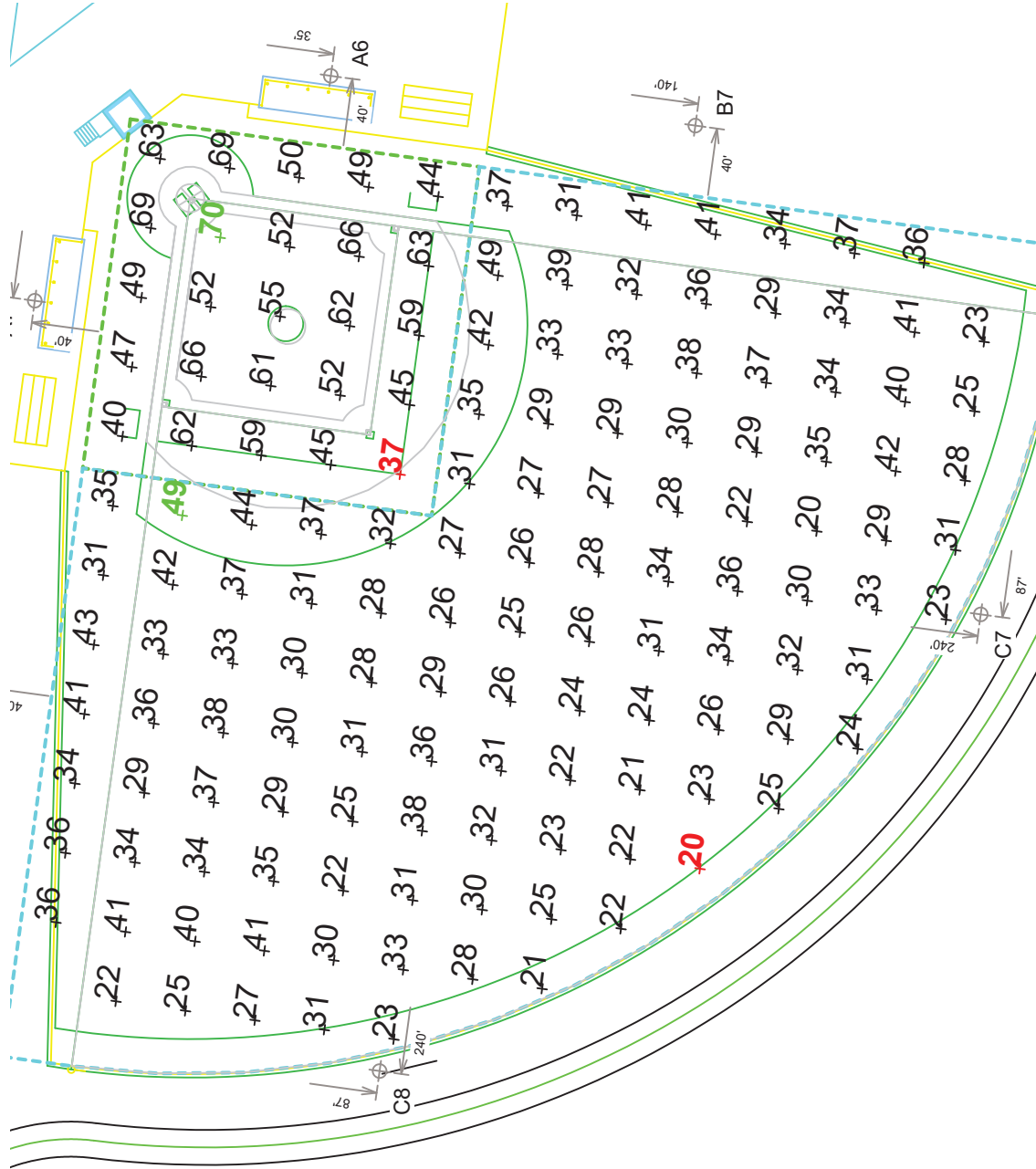

Pole location(s) ⊕ dimensions are relative to 0,0 reference point(s) ⊗

SCALE IN FEET 1 : 50



ENGINEERED DESIGN By: Jason Hoyle • File #174728A_TLC_A • 02-May-18